

# Excel Single Gang Stainless Steel Keystone Faceplate and Back Box 2 Port

Item Code: 100-293



- ✕ Brushed Stainless Steel Faceplates
- ✕ 2 Port Keystone Version
- ✕ Supplied with Standard & Security Screws
- ✕ Single gang 35 mm back box supplied
- ✕ 25 Year system warranty

## Product Overview

Excel Single Gang Stainless Steel Keystone Faceplates allow the deployment of Excel Keystone Jacks in either a 1 Port or 2 Port configuration. They are supplied with a 35 mm deep metal back box that can be drilled to accept conduit entry as required. Each faceplate is supplied with both standard and Torx T10 tamper resistant fixing screws making them ideal for installation in a variety of situations both public and secure. The stainless steel faceplates are designed to have "clean lines" by only showing the shutter and label position.

## Product Specifications

Feature	Values
Number of units	2
Mounting direction	Horizontal
Number of units horizontal	2
Material	Metal
Material quality	Stainless steel
Colour	Stainless steel
Width	86 mm
Height	86 mm

Excel Single Gang Stainless Steel Keystone Faceplate and Back Box 2 Port

Item Code: 100-293



Product drawing

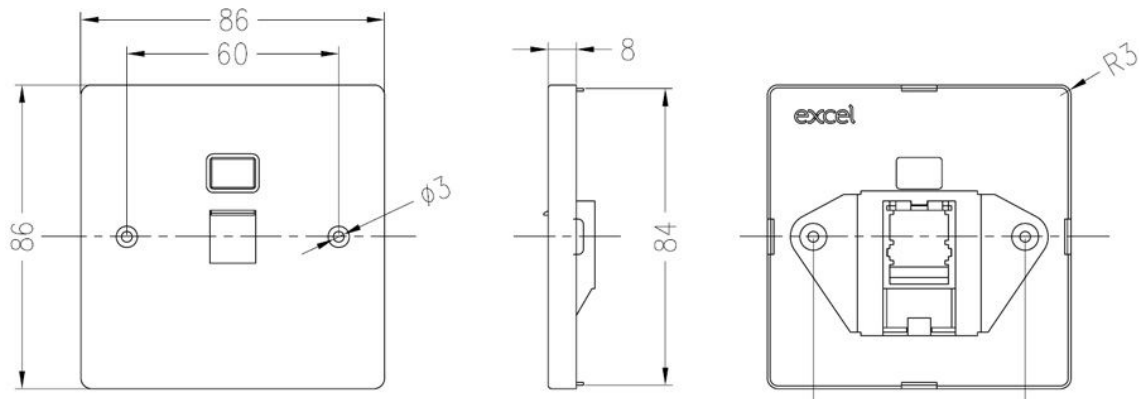

Product drawing

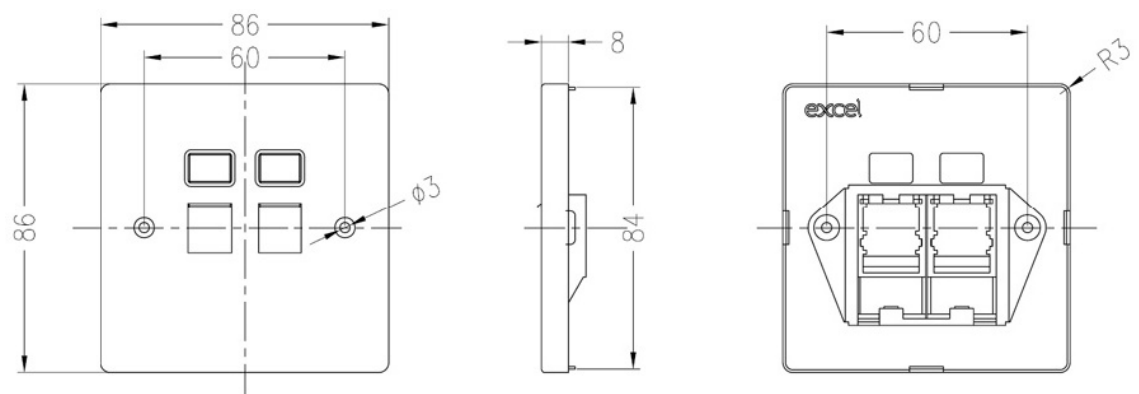

Standards

Applicable standard	Detail
RoHS-II/-III (2011/65/EU & 2015/863): 2023	Our products, demonstrate full adherence to the regulatory stipulations of the EU Directive 2011/65/EU (RoHS-II) and its corresponding delegated directive 2015/863 (RoHS-III).
WFD: 2023	Compliant to Waste Framework Directive
SCIP: 2023	Compliant - Does Not Contain Substances of Concern In articles as such or in complex objects (Products)
POPs (EU) No 2019/1021	EU Regulation for the restriction of Persistent Organic Pollutants.

# Excel Single Gang Stainless Steel Keystone Faceplate and Back Box 2 Port

Item Code: 100-293



## Part Number Table

Part Number	Description
100-292	Excel Single Gang Stainless Steel Keystone Faceplate and Back Box 1 Port
100-293	Excel Single Gang Stainless Steel Keystone Faceplate and Back Box 2 Port

Excel is a world class premium performing end to end infrastructure solution designed, Manufactured, supported and delivered without compromise.

Contact us at [sales@excel-networking.com](mailto:sales@excel-networking.com)



E&OE. Excel is a registered trade name of Mayflex Holdings Ltd.