

# Excel Enbeam Optical Fibre Connector LC Simplex OM3 Multimode Aqua

Item Code: 200-353-AQ

**excel**  
without compromise.



- ✕ High Density, Small Form Factor
- ✕ Singlemode & Multimode variants
- ✕ High precision Ceramic Ferrules
- ✕ Pre-radiused ferrules
- ✕ Colour-Coded shrouds
- ✕ 900 micron and ruggedised boots & crimp included

## Product Overview

Enbeam LC small-form-factor single piece connectors are designed for quick and easy termination either on-site or in the factory. Suitable for use with both loose tube and tight buffered cable, can be used with epoxy or the cold cure termination systems.

The LC range covers Multimode and Singlemode options in both simplex and duplex options, which include all colours - Beige, Aqua, Violet and Blue options for all Multimode and Singlemode fibre types. All connectors have precision Zirconia 1.25mm ceramic ferrules which are pre-radiused for rapid polishing/finishing.

## Product Specifications

Feature	Values
Model	Connector
Suitable for type of fibre	Multi mode
Type of connector	LC
APC-type	no
Connection type	adhere (glue)
Colour	Aqua
Fibre class	OM3

### Additional specifications

Features	Multimode	Singlemode
Insertion Loss	0.3dB Max.	0.3dB Max.
3mm Boot Colour	White	White
0.9mm Boot Coloue	White	White
Durability	1000 matings	1000 matings
Ferrule Material	Zirconia	Zirconia
Ferrule Diameter	1.25mm +/- 0.001	1.25mm +/- 0.001
Ferrule Hole Diameter	127 +/- 0.5 um	126 +/- 0.5 um
Ferrule Pre-Radius	7 to 15mm	7 to 15mm
Connector material	Moulded Polymer	Moulded Polymer
Colour	OM1/OM2 - Beige	Blue
OM3 - Aqua		
OM4 - Violet		
Operating Temperature	-40 to 85C	-40 to 85C

# Excel Enbeam Optical Fibre Connector LC Simplex OM3 Multimode Aqua

Item Code: 200-353-AQ



## Product drawings



- 1 Dust cover
- 2 Beige front housing
- 3 Multimode Ferrule + Flange
- 4 Transparent PVC tube
- 5 Spring
- 6 Beige simplex back housing
- 7 White heat shrink tube  
(plus 1x white heat shrink for duplex style)
- 8 2mm White boot
- 9 White 0.9mm boot

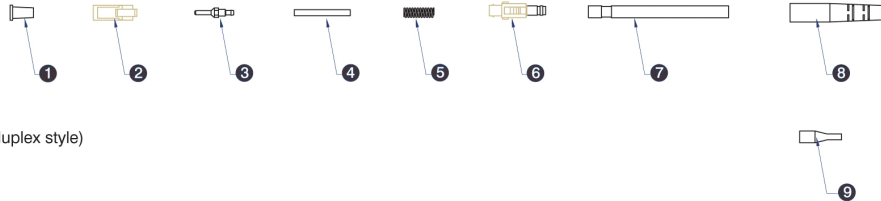

Note: Duplex version consists of 2 of each component shown plus a beige joining clip.

### Singlemode - Simplex



- 1 Dust cover
- 2 Blue front housing
- 3 Singlemode Ferrule + Flange
- 4 Transparent PVC tube
- 5 Spring
- 6 Blue simplex back housing
- 7 Yellow heat shrink tube  
(plus 1x white heat shrink for duplex style)
- 8 2mm White boot
- 9 White 0.9mm boot

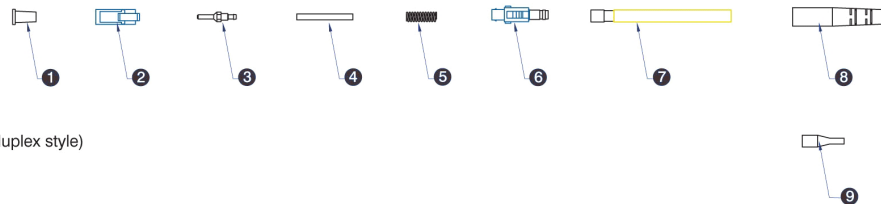

Note: Duplex version consists of 2 of each component shown plus a blue joining clip.

## Standards

Applicable standard	Detail
IEC 61754-2:1996	Fibre optic connector interfaces - Part 2: Type BFOC/2,5 connector family
IEC 61300-2-2:2009	Fibre optic interconnecting devices and passive components - Basic test and measurement procedures - Part 2-2: Tests - Mating durability
IEC 61753-1:2018	Fibre optic interconnecting devices and passive components - Performance standard - Part 1: General and guidance
RoHS-II/III (2011/65/EU & 2015/863): 2023	Our products, demonstrate full adherence to the regulatory stipulations of the EU Directive 2011/65/EU (RoHS-II) and its corresponding delegated directive 2015/863 (RoHS-III).
WFD: 2023	Compliant to Waste Framework Directive
SCIP: 2023	Compliant - Does Not Contain Substances of Concern In articles as such or in complex objects (Products)
POPs (EU) No 2019/1021	EU Regulation for the restriction of Persistent Organic Pollutants.

# Excel Enbeam Optical Fibre Connector LC Simplex OM3 Multimode Aqua

Item Code: 200-353-AQ



## Part Number Table

Part Number	Description
200-349	Excel Enbeam Optical Fibre Connector LC Duplex OS2 Singelmode Blue
200-351	Excel Enbeam Optical Fibre Connector LC Simplex OS2 Singlemode Blue
200-352	Excel Enbeam Optical Fibre Connector LC Duplex OM1/OM2 Multimode Beige
200-352-AQ	Excel Enbeam Optical Fibre Connector LC Duplex OM3 Multimode Aqua
200-352-VT	Excel Enbeam Optical Fibre Connector LC Duplex OM4 Multimode Violet
200-353	Excel Enbeam Optical Fibre Connector LC Simplex OM1/OM2 Multimode Beige
200-353-100	Excel Enbeam Optical Fibre Connector LC Simplex OM1/OM2 Multimode Beige (100-Pack)
200-353-AQ	Excel Enbeam Optical Fibre Connector LC Simplex OM3 Multimode Aqua
200-353-VT	Excel Enbeam Optical Fibre Connector LC Simplex OM4 Multimode Violet

Excel is a world class premium performing end to end infrastructure solution designed, Manufactured, supported and delivered without compromise.

Contact us at [sales@excel-networking.com](mailto:sales@excel-networking.com)



E&OE. Excel is a registered trade name of Mayflex Holdings Ltd.