

Excel Encasa Din Rail SCA Module 2 Fibre with 50 m OS2 G.657.A2 4 mm Drop Cable

Item Code: 207-401-50



✕ Integrated fibre management

✕ Hinged doors

✕ DIN rail release latch

✕ Shuttered adaptors

Product Overview

The Excel Encasa DIN rail mount box has been designed for industrial and FTTH application. The outlet is fixed direct to the DIN rail and offers a compact solution that can be installed in confined spaces requiring connectivity.

Pre-terminated with a 2 core 900 µm Cca-s1a,d0,a1 drop cable 50 m in length terminated one end with 2x SC/APC connectors and open at the other, allows quick installation within the customer premises.

Product Specifications

Feature	Values
Surface mounted	yes
Type of connector	SC/APC simplex
With couplers	yes
Suitable for number of couplers	2
Suitable for type of fibre	Single mode
Width	18 mm
Height	85 mm
Depth	61 mm

Excel Encasa Din Rail SCA Module 2 Fibre with 50 m OS2 G.657.A2 4 mm Drop Cable

Item Code: 207-401-50



Additional specifications

Features	Values
Colour	White
Operating temperature	-20 to +85 °C
Cable diameter	4mm
Fibre type	9/125 G.657.A2
Core size	900µm
Reaction-to-fire class according to EN 13501-6	Cca
Smoke development class according to EN 13501-6	s1a
Euro class flaming droplets/particles according to EN 13501-6	d0
Euro class acidity according to EN 13501-6	a1
UL-94-V-0	Yes

Excel Encasa Din Rail SCA Module 2 Fibre with 50 m OS2 G.657.A2 4 mm Drop Cable

Item Code: 207-401-50



Product drawings

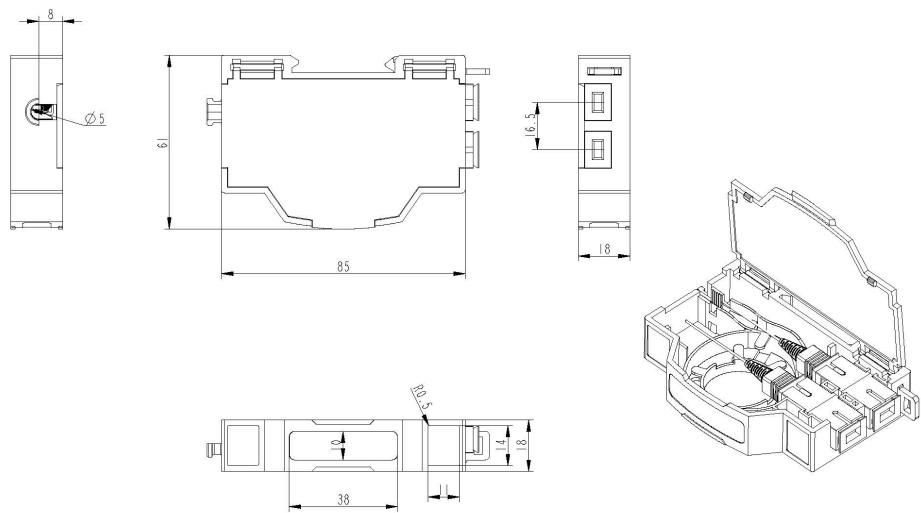

Standards

Applicable standard	Detail
IEC 61754-1:2013	Fibre optic interconnecting devices and passive components - Fibre optic connector interfaces - Part 1: General and guidance
ISO/IEC 11801-1:2017	Information technology - Generic cabling for customer premises: Part 1 General Requirements
EN 50173-1:2018	Information technology. Generic cabling systems - General requirements
UL-94-V-0	Burning stops within 10 seconds after two applications of ten seconds each of a flame to a test bar. NO flaming drips are allowed.
RoHS-II/-III (2011/65/EU & 2015/863): 2023	Our products, demonstrate full adherence to the regulatory stipulations of the EU Directive 2011/65/EU (RoHS-II) and its corresponding delegated directive 2015/863 (RoHS-III).
WFD: 2023	Compliant to Waste Framework Directive

Excel Encasa Din Rail SCA Module 2 Fibre with 50 m OS2 G.657.A2 4 mm Drop Cable

Item Code: 207-401-50



SCIP: 2023	Compliant - Does Not Contain Substances of Concern In articles as such or in complex objects (Products)
POPs (EU) No 2019/1021	EU Regulation for the restriction of Persistent Organic Pollutants.

Part Number Table

Part Number	Description
207-400-30	Excel Encasa Din Rail SCA Module 1 Fibre with 30 m OS2 G.657.A2 4 mm Drop Cable
207-400-50	Excel Encasa Din Rail SCA Module 1 Fibre with 50 m OS2 G.657.A2 4 mm Drop Cable
207-401-30	Excel Encasa Din Rail SCA Module 2 Fibre with 30 m OS2 G.657.A2 4 mm Drop Cable
207-401-50	Excel Encasa Din Rail SCA Module 2 Fibre with 50 m OS2 G.657.A2 4 mm Drop Cable

Excel is a world class premium performing end to end infrastructure solution designed, Manufactured, supported and delivered without compromise.

Contact us at sales@excel-networking.com



E&OE. Excel is a registered trade name of Mayflex Holdings Ltd.