

DC Rack Southco Lock Kit 2 Handles to Intelligent PDU

Item Code: 546-SCO-KT4



- Complete electronic handle kit
- Handles, actuators and wiring looms
- Supports most RFID card types 2K and 4K
- Only suitable for DCR racks
- Alternative to issuing keys for entry
- Cannot be fitted to CR and WR series steel doors

Product Overview

These upgrade kits are available to enable an easy upgrade option to electronic handles on the DC range of racks. The kits include handles, actuators to connect to door rods, harness cables and adaptors. Kits KT1 and KT2 also come with the Southco Interconnect Box, KT3 and KT4 come with adaptors to use with an excel Intelligent PDU, INT1, INT2, INT3 or INT4.

The kits use the Southco H3-EM-66 handle which support RFID reader cards providing an easy access control solution for the Data Centre Racks. Kits can be used for Front or Rear doors, on rear doors re-fit the door cam fitted on the original lock.

Product Specifications

Feature	Values
Type of handle	Door handle
Padlock	no
Espagnolette locking (3-point locking)	yes
Type of closure	Card lock

DC Rack Southco Lock Kit 2 Handles to Intelligent PDU

Item Code: 546-SCO-KT4



Product drawing

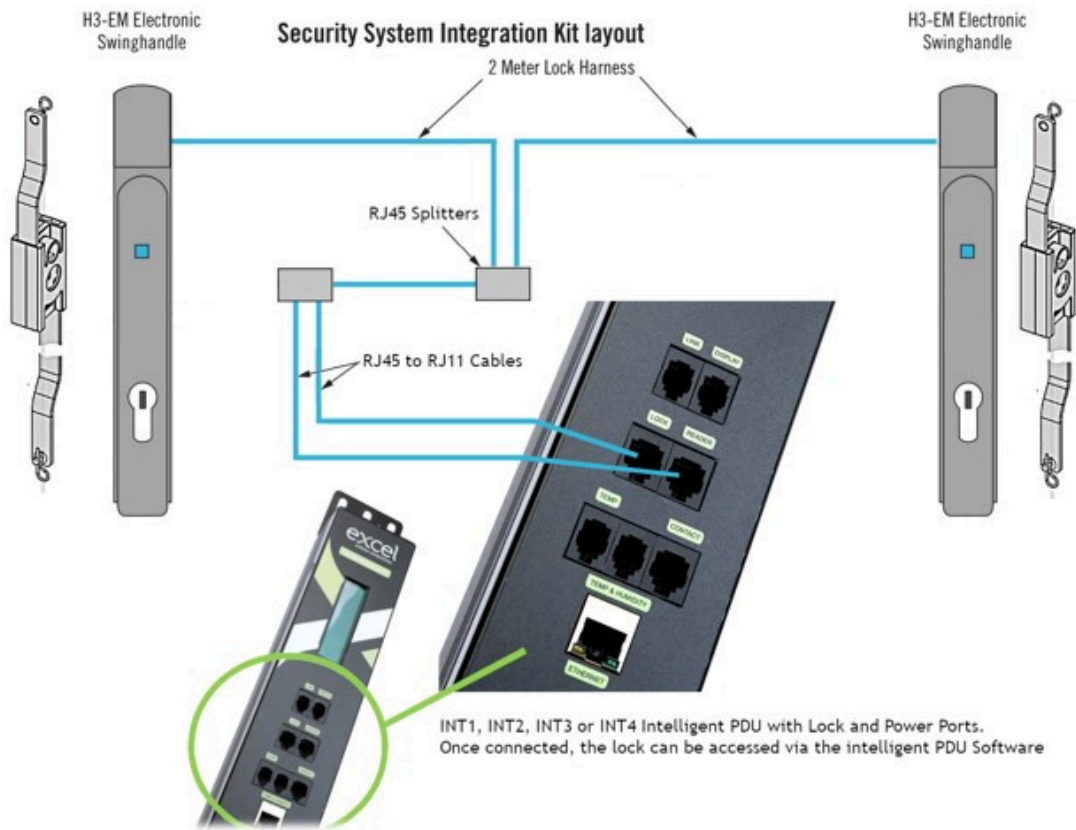

Standards

Applicable standard	Detail
RoHS-II/-III (2011/65/EU & 2015/863): 2023	Our products, demonstrate full adherence to the regulatory stipulations of the EU Directive 2011/65/EU (RoHS-II) and its corresponding delegated directive 2015/863 (RoHS-III).
POPs (EU) No 2019/1021	EU Regulation for the restriction of Persistent Organic
WFD: 2023	Compliant to Waste Framework Directive
SCIP: 2023	Compliant - Does Not Contain Substances of Concern In articles as such or in complex objects (Products)
POPs (EU) No 2019/1021	EU Regulation for the restriction of Persistent Organic Pollutants.

DC Rack Southco Lock Kit 2 Handles to Intelligent PDU

Item Code: 546-SCO-KT4



Part Number Table

Part Number	Description
546-SCO-KT3	DC Rack Southco Lock Kit 1 Handle to Intelligent PDU
546-SCO-KT4	DC Rack Southco Lock Kit 2 Handles to Intelligent PDU
546-SCO-KT8	DC Rack Southco Lock Kit Euro Unloaded 2 Handles to Intelligent PDU

Excel is a world class premium performing end to end infrastructure solution designed, Manufactured, supported and delivered without compromise.

Contact us at sales@excel-networking.com



E&OE. Excel is a registered trade name of Mayflex Holdings Ltd.