

Excel Hinged Wall Mount Frame Network Data Cabinet 4U WxD 521mm x 170mm Black

excel
without compromise.

Part Code: WB4UB

sales@excel-networking.com
excel-networking.com

CIBSE TM65 Embodied Carbon: 20.165 kg CO2e



Main Features

- / Available in 2U/3U/4U/6U
- / Hinged frame allows rear access
- / 25 year system warranty
- / Compact low profile design
- / Lid and base included
- / CIBSE TM65 Embodied Carbon: 20.165 kg CO2e

Product Overview

Excel Hinged Wall Mount Frame Network Data Cabinet 4U WxD 521 mm x 170 mm Black, part of a huge range of Network Data Cabinets available from Mayflex.

This compact wall mounted frame is ideal for cabling installations of a small number of points. Any number of units can be fixed together.

Product Specifications

Excel Hinged Wall Mount Frame Network Data Cabinet 4U WxD 521mm x 170mm Black

Part Code: WB4UB

sales@excel-networking.com
excel-networking.com

Feature	Values
Mounting Profile	Front side
Model	Hinged frame
Type of profile rail	L-shaped
Width	521 mm
Height	180.6 mm
Depth	170 mm
Modular spacing	19 inch
Number of rack units (RU)	4
With roof plate	yes
With front door	no
Side panels included	yes
Flat-packed	no
Material	Steel
Type of surface	Powder coated
Colour	Black

Excel Hinged Wall Mount Frame Network Data Cabinet 4U WxD 521mm x 170mm Black

Part Code: WB4UB

sales@excel-networking.com
excel-networking.com

Product drawings (2U and 3U versions)

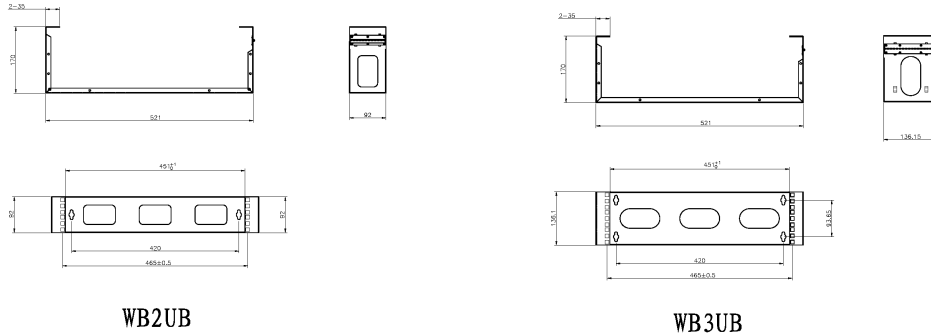

WB2UB

WB3UB

Product drawings (4U and 6U versions)

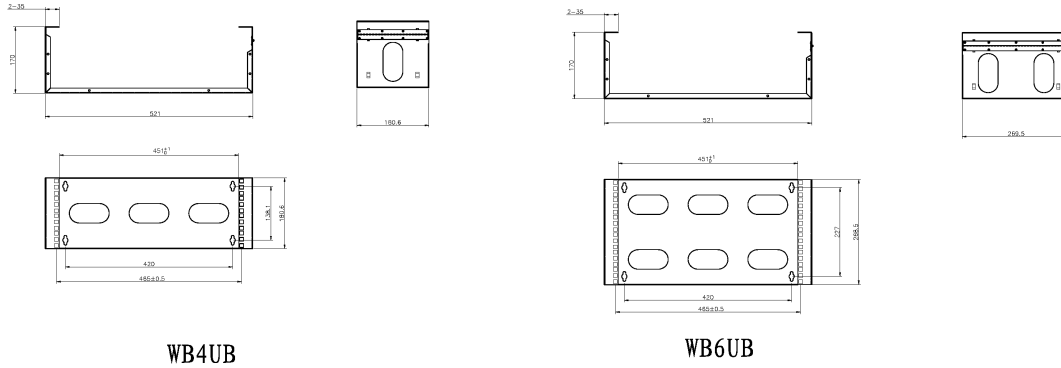

WB4UB

WB6UB

Part Code Table

Part Code	Description
WB2UB	Excel Hinged Wall Mount Frame Network Data Cabinet 2U WxD 521mm x 170mm Black
WB3UB	Excel Hinged Wall Mount Frame Network Data Cabinet 3U WxD 521mm x 170mm Black
WB4UB	Excel Hinged Wall Mount Frame Network Data Cabinet 4U WxD 521mm x 170mm Black

Excel Hinged Wall Mount Frame Network Data Cabinet 4U
WxD 521mm x 170mm Black



Part Code: WB4UB

sales@excel-networking.com
excel-networking.com

WB6UB

Excel Hinged Wall Mount Frame Network Data Cabinet 6U WxD 521mm x
170mm Black